



**FOR LEASE OR SALE** | **258,974 SF**  
**5055 N LYDELL AVE** | **GLENDALE, WI**

**PATRICK DEDERING** | 414-376-6933 | [PATRICK@PHOENIXINVESTORS.COM](mailto:PATRICK@PHOENIXINVESTORS.COM)  
**LUKE HERDER** | 414-244-9575 | [LHERDER@PHOENIXINVESTORS.COM](mailto:LHERDER@PHOENIXINVESTORS.COM)  
**JEFF KILBORN** | 414-214-0613 | [JKILBORN@PHOENIXINVESTORS.COM](mailto:JKILBORN@PHOENIXINVESTORS.COM)



**PHOENIX**  
**INVESTORS**

*Opportunity. Execution. Value Creation.*

This document has been prepared by Phoenix Investors for advertising and general information only. Phoenix Investors makes no guarantees, representations, or warranties of any kind, expressed or implied, regarding the information including, but not limited to, warranties of content, accuracy, and reliability.



# PROPERTY HIGHLIGHTS



**OFFICE CAN BE CONVERTED TO WAREHOUSE SPACE**



**IDEAL LAST-MILE FACILITY LOCATION**



**LOCATED IN THE HIGHLY DESIRABLE NORTHSHORE AREA**



**LOFT-LIKE OFFICE SPACE WITH HIGH CEILINGS**



**FEATURES COMMERCIAL-GRADE KITCHEN, DATA ROOM, AND BACK-UP GENERATOR**



**ELECTRONIC PASSCARD ACCESS, MOTION DETECTORS, AND CAMERAS**



**ADJACENT TO OAK LEAF TRAIL**



**EASY ACCESS TO I-43 AND EAST/WEST ARTERIALS**



# PROPERTY DETAILS

5055 NORTH LYDELL AVE | GLENDALE, WI

AVAILABLE SPACE	258,974 SF
MINIMUM DIVISIBLE	4,909 SF
WAREHOUSE SPACE	58,980 SF
OFFICE SPACE	196,519 SF
FLOORS	2
ELEVATORS	1 Passenger
DOCK DOORS	1
DRIVE-IN DOORS	3
CLEAR HEIGHT	8' in 2-Story East Building   15' - 22' in Single-Story First Floor Offices   24' in North Warehouse Area
ROOF	TPO/Pitched Metal Panel
WALLS	Masonry
FLOORS	6" Reinforced Concrete
YEAR BUILT	1956   Renovated in 2002
FIRE SUPPRESSION	100% Wet, Except Data Center with Dedicated Fire Suppression
LIGHTING	LED
POWER	3-Phase 480V/1600 Amp Service
PARKING	874 Surface Spaces
LAND AREA	15.56 Acres
ZONING	B-1: Local Business District, Sub Area A
PARCEL ID	203-899-5004
<b>OPEX ESTIMATE</b>	<b>\$0.93/SF</b>



# FLOOR PLAN

5055 NORTH LYDELL AVE | GLENDALE, WI

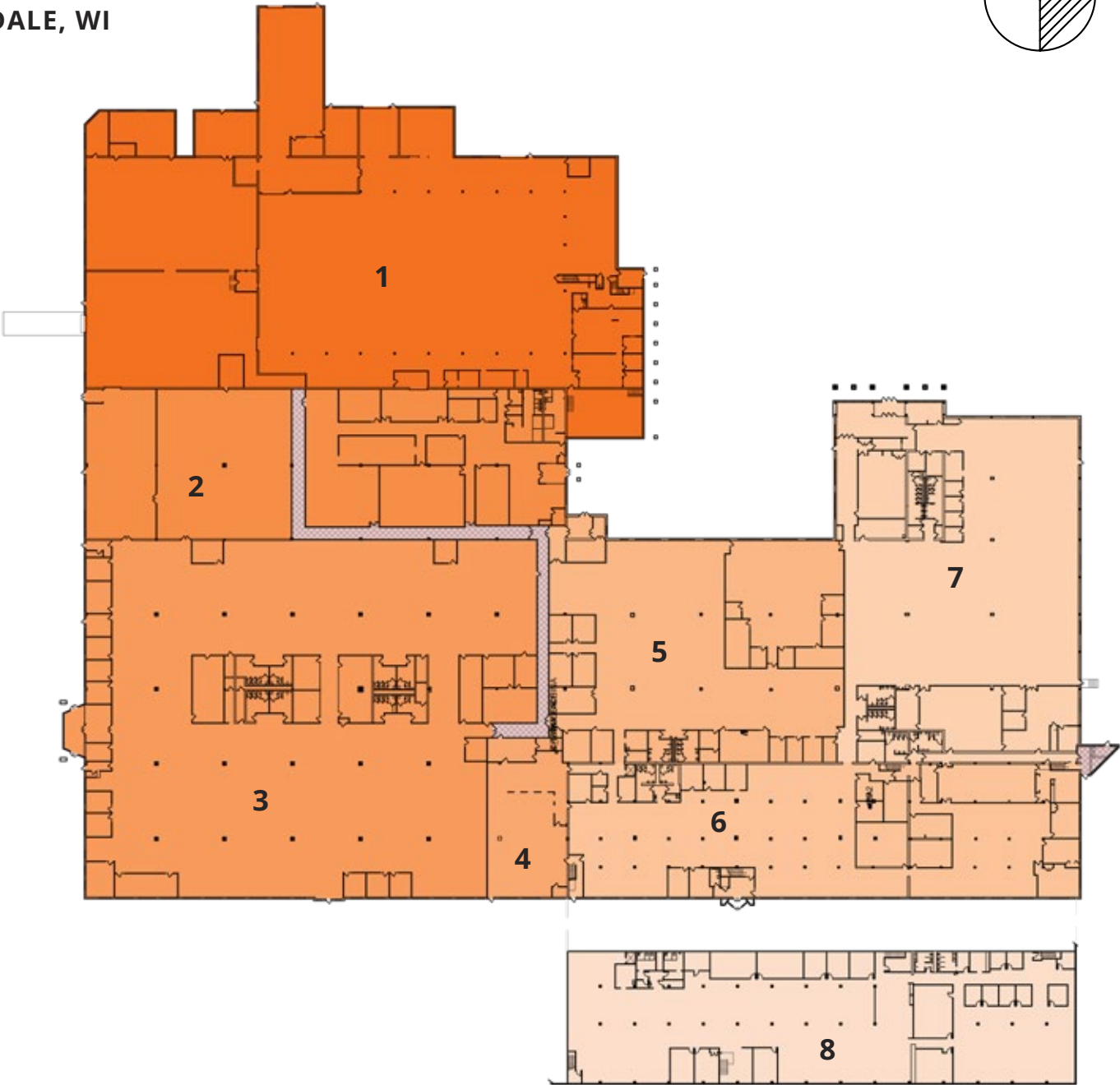
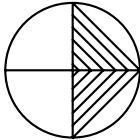

NUMBER	SPACE DESIGNATION	SQUARE FEET
1	AVAILABLE	58,980 SF
2	AVAILABLE	25,646 SF
3	AVAILABLE	59,012 SF
4	AVAILABLE	4,909 SF
5	AVAILABLE	25,475 SF
6	AVAILABLE	26,506 SF
7	AVAILABLE	32,536 SF
8	AVAILABLE	25,910 SF
<b>TOTAL</b>		<b>258,974 SF</b>

# LOCATION MAP

5055 NORTH LYDELL AVE | GLENDALE, WI

PORT OF MILWAUKEE	9 MILES
MITCHELL INT'L AIRPORT	15 MILES
CHICAGO	90 MILES
INDIANAPOLIS	280 MILES
MINNEAPOLIS	330 MILES

