



**FOR LEASE OR SALE** | **183,859 SF**  
**61312 HWY 278** | **AMORY, MS**

**KURT JENSEN** 262-308-0008 | [KURT@PHOENIXINVESTORS.COM](mailto:KURT@PHOENIXINVESTORS.COM)

**MICHAEL JENSEN** | 414-260-0577 | [MJENSEN@PHOENIXINVESTORS.COM](mailto:MJENSEN@PHOENIXINVESTORS.COM)



**PHOENIX**  
**INVESTORS**

*Opportunity. Execution. Value Creation.*

This document has been prepared by Phoenix Investors for advertising and general information only. Phoenix Investors makes no guarantees, representations, or warranties of any kind, expressed or implied, regarding the information including, but not limited to, warranties of content, accuracy, and reliability.

# PROPERTY DETAILS

61312 HWY 278 | AMORY, MS

AVAILABLE SPACE	183,859 SF
WAREHOUSE SPACE	182,132 SF
OFFICE SPACE	1,727 SF
MINIMUM DIVISIBLE	50,000 SF
DOCK WITH LEVELERS	19
DOCK HIGH DOORS	1
OH GRADE-LEVEL DRIVE-IN	3
COLUMN SPACING	30' x 50'
CLEAR HEIGHT	13' 4" - 19' 5"
ROOF	Galvanized Metal/SPF
YEAR BUILT	1968
POWER	3-Phase
PARKING	25 Standard   32 Trailer
LAND AREA	12.8 Acres



# PROPERTY HIGHLIGHTS



~17 UNITS (FORCED AIR/AC)



LAYDOWN YARD & TRAILER  
PARKING AVAILABLE

# FLOOR PLAN

61312 HWY 278 | AMORY, MS

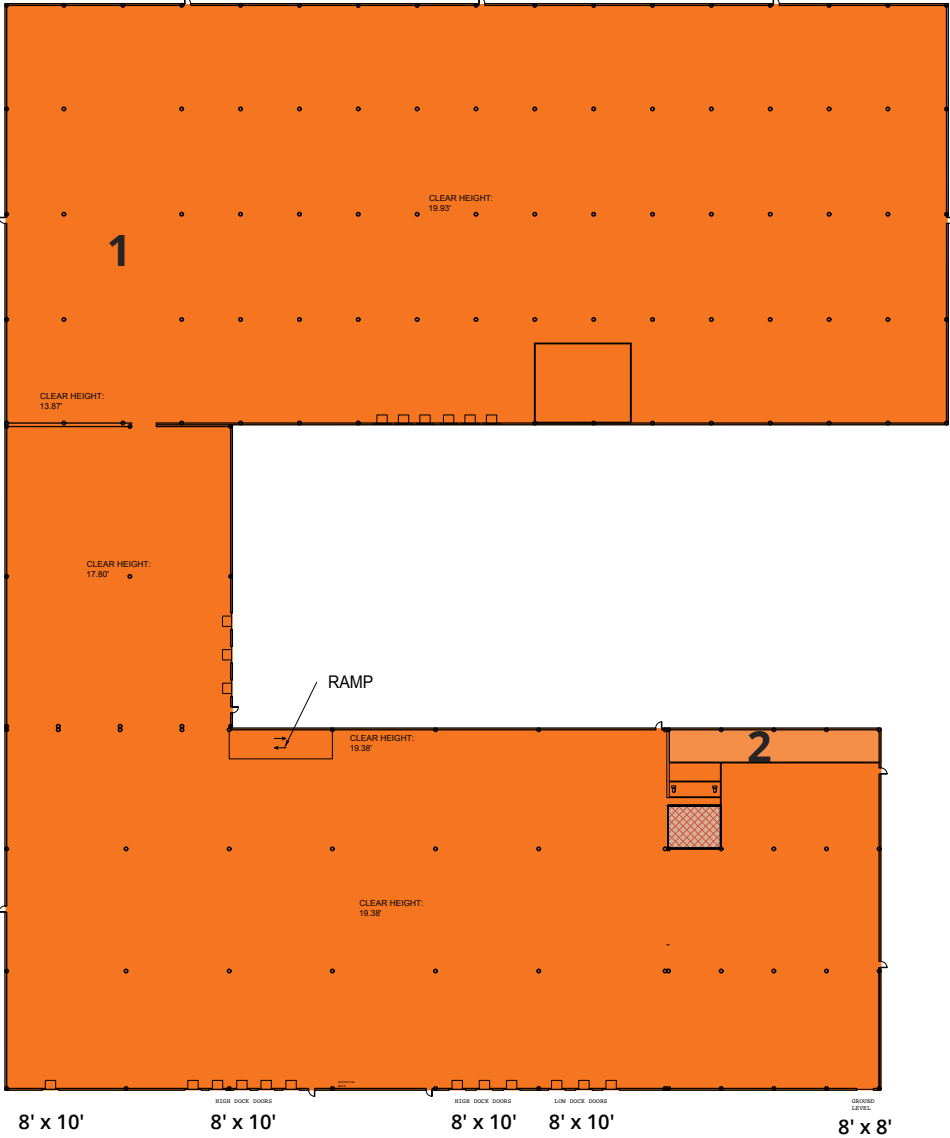

NUMBER	SPACE DESIGNATION	CLEAR HEIGHT	COLUMN SPACING	DOCKS	OH DOORS	RESTROOMS	SQUARE FEET
1	WAREHOUSE	13' 4" - 19' 5"	30' x 50'	19	3	2	182,132 SF
2	OFFICE	DROP	N/A	N/A	N/A	N/A	1,727 SF
<b>TOTAL</b>							<b>183,859 SF</b>

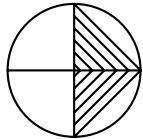

# LOCATION MAP

61312 HWY 278 | AMORY, MS

I-22	26 MILES
BIRMINGHAM, AL	113 MILES
HUNTSVILLE, AL	139 MILES
MEMPHIS, TN	150 MILES
NASHVILLE, TN	229 MILES

