



FOR LEASE OR SALE | **299,885 SF**
1 POULAN DRIVE | **NASHVILLE, AR**

MICHAEL JENSEN | 414-260-0577 | MJENSEN@PHOENIXINVESTORS.COM
ANTHONY CRIVELLO | 414-982-4810 | ANTHONY@PHOENIXINVESTORS.COM



PHOENIX
INVESTORS

Opportunity. Execution. Value Creation.

This document has been prepared by Phoenix Investors for advertising and general information only. Phoenix Investors makes no guarantees, representations, or warranties of any kind, expressed or implied, regarding the information including, but not limited to, warranties of content, accuracy, and reliability.



PROPERTY HIGHLIGHTS



**6,600-SF CAFETERIA/
KITCHEN AREA**



**FENCED LOT WITH
GATED ACCESS**



**GREAT ACCESS TO STATE
HWY 27 WITH CONNECTIVITY
TO I-30**



16 DOCK DOORS



**OUTDOOR COVERED
STORAGE**



PROPERTY DETAILS

1 POULAN DRIVE | NASHVILLE, AR

| | |
|----------------------------|--|
| AVAILABLE SPACE | 299,885 SF |
| WAREHOUSE SPACE | 279,300 SF |
| MEZZANINE SPACE | 20,585 SF |
| DOCK DOORS | 16 |
| GRADE-LEVEL DRIVE-IN DOORS | 2 |
| CLEAR HEIGHT | 18' 8" - 36' 8" |
| COLUMN SPACING | 40' x 40' |
| YEAR BUILT | 1976 |
| POWER | 6K, 4K, & 2K Amp Service 3-Phase 480Y 277 V |
| PARKING | 95 Auto 17 Trailer |
| LAND AREA | 76.61 Acres |
| ZONING | Industrial |
| PARCEL ID | 750-00435-0001 |



FLOOR PLAN

1 POULAN DRIVE | NASHVILLE, AR

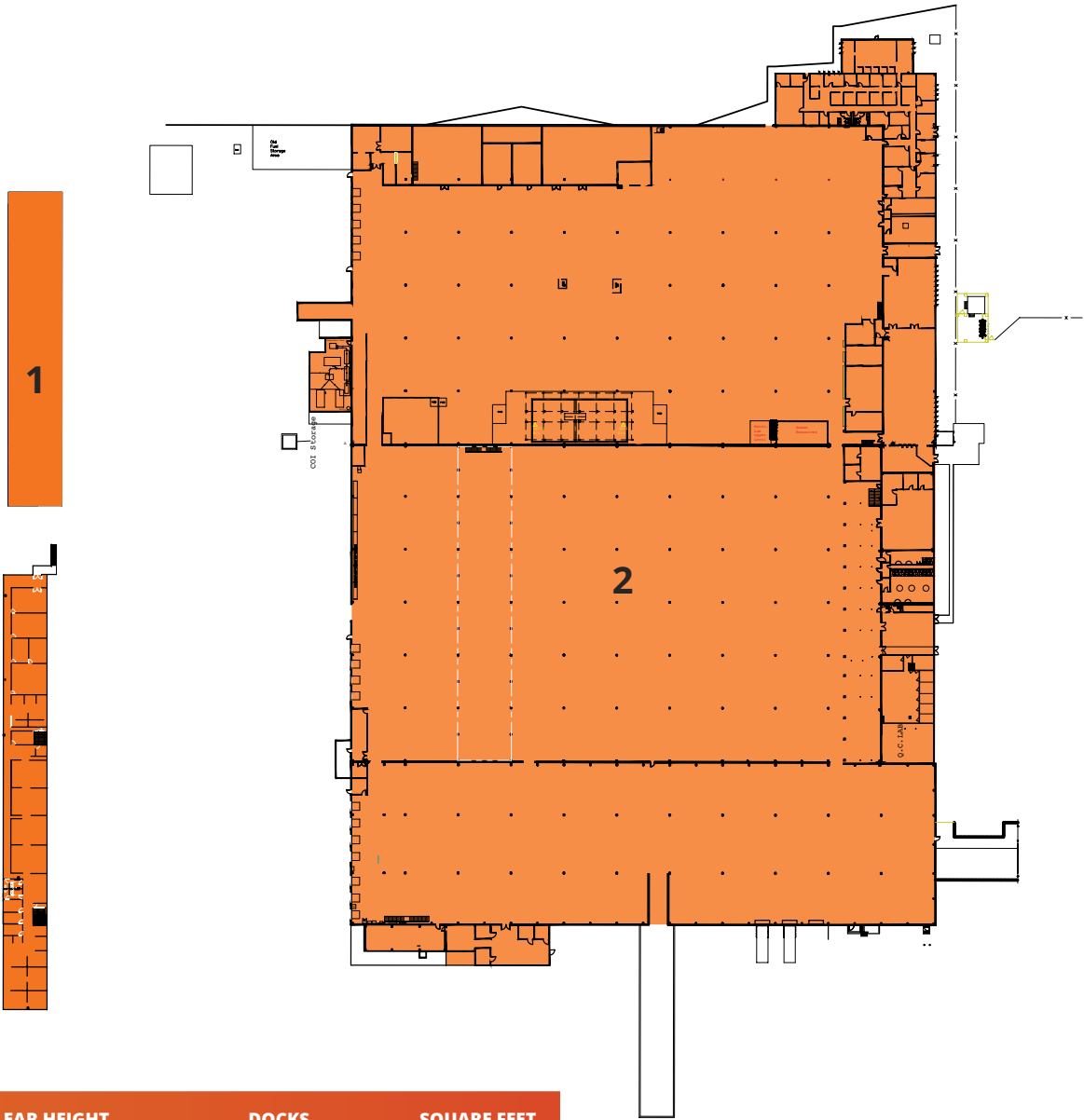

| NUMBER | SPACE DESIGNATION | COLUMN SPACE | CLEAR HEIGHT | DOCKS | SQUARE FEET |
|--------------|-------------------|--------------|-----------------|-------|-------------------|
| 1 | MEZZANINE | N/A | DROP | N/A | 20,585 SF |
| 2 | WAREHOUSE | 40' x 40' | 18' 8" - 36' 8" | 16 | 279,300 SF |
| TOTAL | | | | | 299,885 SF |

LOCATION MAP

1 POULAN DRIVE | NASHVILLE, AR

| | |
|-----------------|-----------|
| LITTLE ROCK, AR | 123 MILES |
| DALLAS, TX | 216 MILES |
| MEMPHIS, TN | 265 MILES |
| JACKSON, MS | 292 MILES |

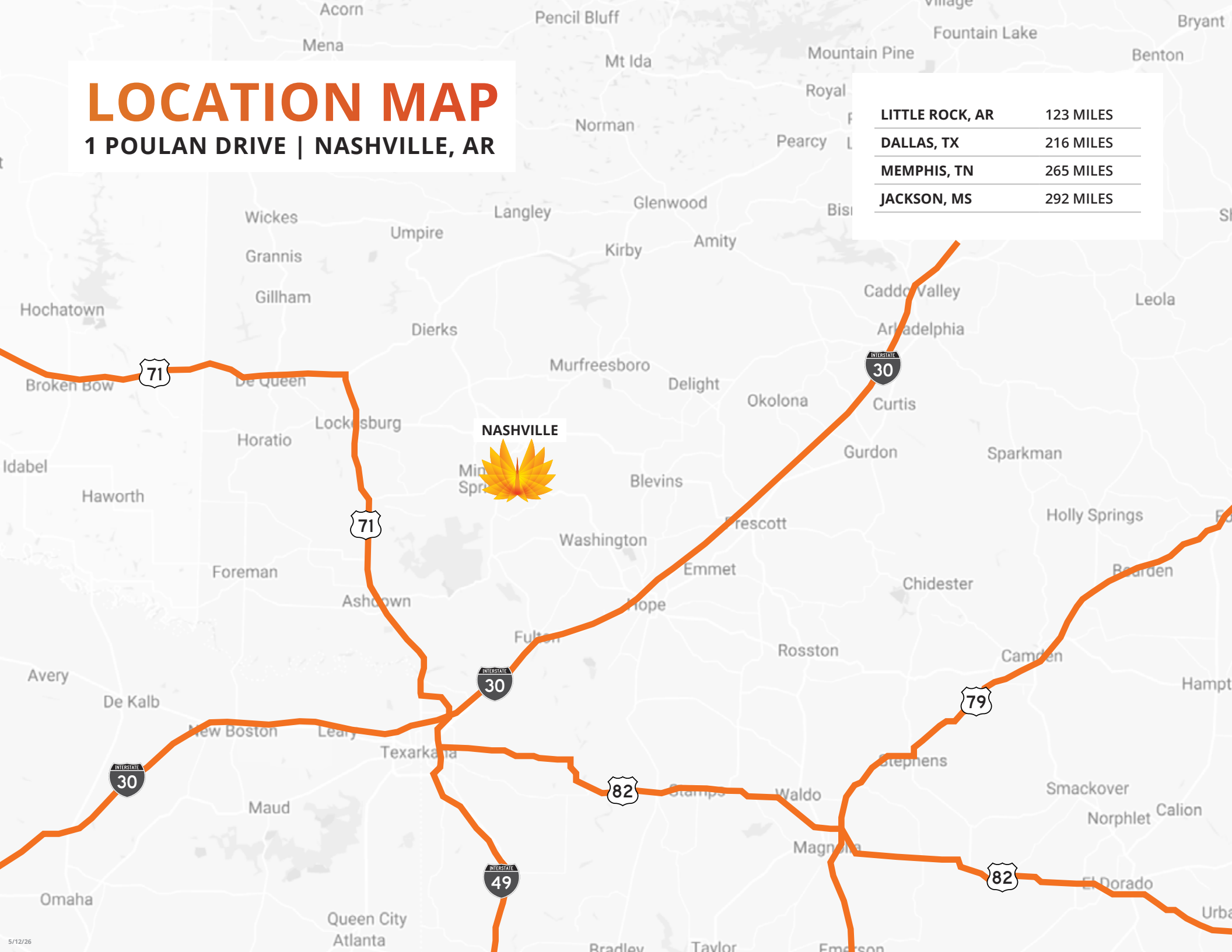

NASHVILLE

